



ANZAC MEMORIAL CENTENARY PROJECT

Construction Information – August 2016



About the Project

As Australia marks the 100th anniversary of the First World War the NSW Government, together with the Trustees, is enhancing the Anzac Memorial. The project will realise the vision of the original architect, Bruce Dellit, and introduce new spaces for the community, allowing the Memorial to tell the stories of NSW's involvement in all military and peace-keeping missions and honour those who have served. The \$40 million upgrade is jointly funded by the NSW and Australian Governments. For further information visit: www.anzacmemorial.nsw.gov.au/anzac-memorial-centenary-project

About Built

Built has been appointed to deliver the construction of the Centenary Project on behalf of Infrastructure NSW and the Trustees of the Anzac Memorial Building. Built is Australian owned and one of the largest construction groups in the country. Built has extensive experience in heritage buildings having recently completed the major refurbishment of the Australian War Memorial in Canberra and the refurbishment of the heritage-listed Gowings and State Theatre buildings in Sydney.

Built.

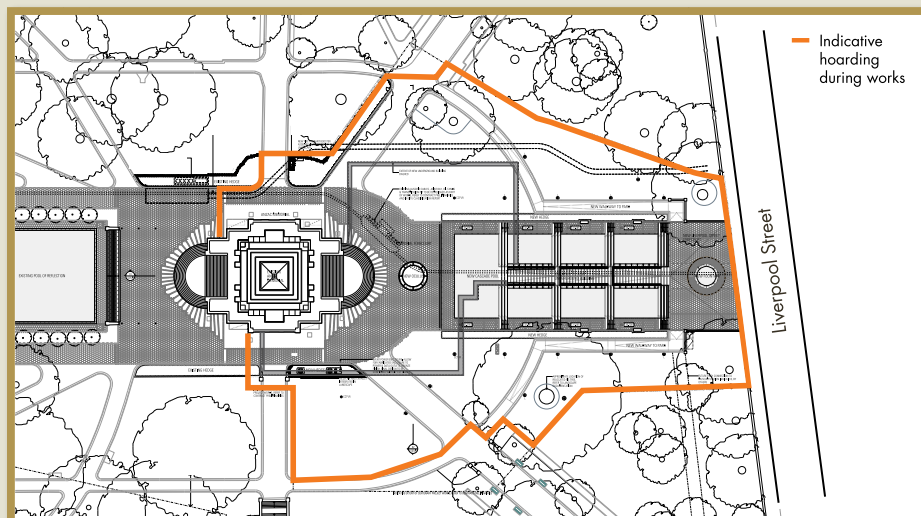

Construction Information

What to expect during construction:

- Hoardings enclosing the Anzac Memorial Centenary Project construction area will be installed during the next couple of weeks.
- All efforts will be made to minimise disruption. Daily commemorative services will continue.

Construction Program

Works will commence in early September with works due to be completed as the centenary commemorations draw to a close in 2018.

Access

The public will be able to access parts of the Memorial throughout all the phases of construction. Entry points may change but will always be clearly sign-posted. Pedestrian paths will be modified within the Memorial's precinct in Hyde Park South in collaboration with the City of Sydney to avoid construction zones while ensuring the public's access and enjoyment of Hyde Park is maintained.

Standard Work Hours

Monday to Friday:	7:00am – 7:00pm
Saturday:	7:00am – 5:00pm
Sunday:	No work

Construction equipment and materials will be delivered onto the site via Liverpool Street, with all efforts made to minimise impact to pedestrians and local traffic.

Any questions?

Please email or telephone us on the details below.

Community Hotline

1300 938 002

Email

anzacmemorial@built.com.au

Built.